

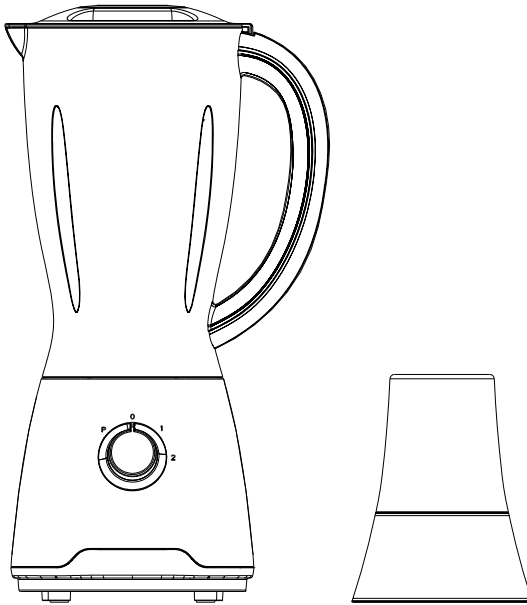

Blender

INSTRUCTION MANUAL



MODEL: RM/367

Read this booklet thoroughly before using and save it for future reference

IMPORTANT SAFEGUARDS

When using electrical appliance. Basic safety precautions should always be followed including the following:

1. Read all instructions.
2. Before using check that the voltage power corresponds to the one shown on the appliance nameplate.
3. Do not let cord hang over edge of table or counter.
4. Do not operate any appliance with a damage cord or plug or after the appliance malfunction or has been damaged in any manner. Return the appliance to the nearest authorized service facility for examination, repair or adjustment.
5. If the supply cord is damaged, it must be replaced by the manufacture or its service agent or a similarly quality person in order to avoid a hazard .
6. Close supervision is necessary when any appliance is used by or near children.
7. Avoid contacting moving parts.
8. Blades are sharp, so handle carefully.
9. Never use hot liquids or run the appliance empty.

10. The use of accessory not recommended or sold by the manufacturer may cause fire, electric shock or injury.
11. The appliance can not be used for blending or grinding hard and dry substance, otherwise the blade could be blunted. But it can be used for blending ice cube.
12. Unplug from outlet when not in use, before putting on or taking off parts, and before cleaning.
13. To protect against risk of electrical shock do not put unit in water or other liquid.
14. Be sure blending cover is accurately put in place before operating appliance
15. Keep hands and utensils out of container while blending or grinding to reduce the risk of severe injury to persons or damage to the blender. A scraper may be used but must be used only when the blender is not running.
16. To reduce the risk of injury, never place cutter-assembly blades on base without jar or bowl properly attached.
17. This appliance is not intended for used by persons

(including children) with reduced physical, sensory or mental capabilities, or lack of experience and knowledge, unless they have been given supervision or instruction concerning use of the appliances by a person responsible for their safety.

18. Children should be supervised to ensure that they do not play with the appliance.
19. Do not immerse the Motor Unit into water or other liquids.
20. Do not use outdoors.
21. Save these instructions.

HOUSEHOLD USE ONLY

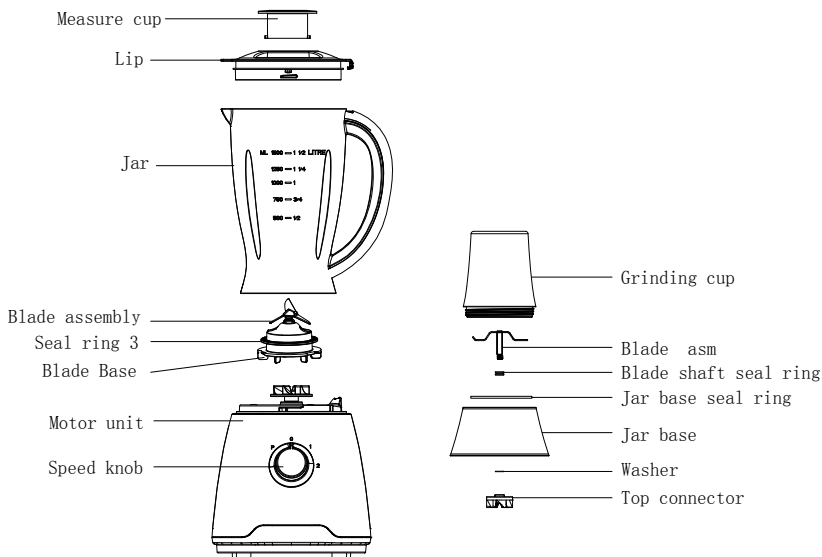

BEFORE THE FIRST USE

Check that all parts are complete and not damaged. Choose the appropriate attachment to perform your desired task. The blending attachment is suitable for blending fruits or vegetables and crushing ice, while the grinding attachment for grinding coffee beans or other granular beans. Clean the attachment according to the section “**CLEANING AND MAINTENANCE**”.

WARNING: The blade is sharp, handle with great care and ensure that unplug the appliance from outlet before assembling and removing parts.

USE YOUR BLENDER

For blending operation

1. Lay the motor unit on the flat horizontal surface and make sure it is unplugged.
2. Place the Jar on the **Motor Unit**, let the triangle almost align with the word “**UNLOCK** ” on jar base and then turn the jar clockwise until the triangle aligns with the word “ **LOCK** ”, a click will be heard when locked into position properly. Please see Fig.1.

NOTE: There is a safety interlock device at the bottom of jar, if

the jar is not assembled in place, the blender will not operate.

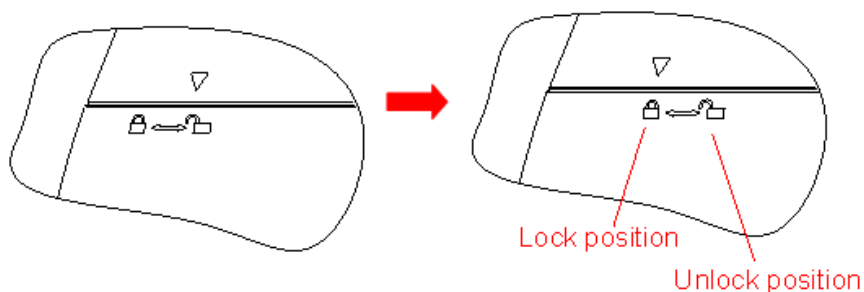

Fig. 1

3. Open the jar cover by turning anticlockwise and place it on the surface. Peel or core the fruits or vegetables and then cut it into small pieces, then put them into the jar. Usually certain amount of purified water has to be added to facilitate the smooth running of appliance. The amount of mixture should not exceed the max level as indicated on the jar, nor sit lower the min level. The best proportion of the fruits or vegetables and water is 2:3.

NOTE: The blender is not applicable for beating egg white, mashing potatoes, mixing dough, extracting juice from fruit and vegetable.

4. Replace jar cover on the jar and turn it clockwise.

NOTE: There is a safety interlock device at the side of jar cover, if the jar cover is not assembled in place, the

blender will not operate.

5. The ingredients may be added into the jar through the center opening of jar cover during operation, then replace measuring cup if necessary. Let the tabs of measuring cup aligns with the grooves of jar cover, put down and turn the measuring cup by clockwise until it in place.
6. Ensure the **speed selector** at the “0” Position, then plug into power outlet and turn the **speed selector** to the desired setting, there are four setting: 0, 1, 2, PULSE. The “1” setting is the low speed, the “2” setting is the high speed. During blending, you may turn the speed selector to “**Pulse**” Position without releasing it if want to accelerate the process of blending.

NOTE: Make sure the jar cover is placed in position completely before operating, and never open the jar cover during operation.

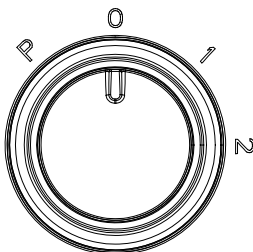

7. Do not run the appliance for more than 3 minutes per time, and only wait until the unit is cooled to room temperature before performing next operation cycle.
8. Turn the **Speed Selector** to “0” position once the mixture has been blended to your desired consistency.
9. Turn the jar anti-clockwise and remove it from the motor unit, carefully take down the jar cover, then pour and serve.

HOW TO USE

Before initial use

1. Before first use, unpack the appliance and place all parts on a horizontal surface.
2. The jar assembly (including the measure cup, lid, seal ring 1, jar, seal ring 2 , blade assembly and jar base) has already been assembled into the motor unit. Disassemble to wash all detachable parts except the motor unit. Refer to the latter chapter CARE AND CLEANING.
3. Once all pieces have been cleaned and dry thoroughly, reassemble.
 - 1) Invert the jar onto a level surface, holding the jar handle, put the the seal ring 2 and blade assembly onto the jar base bottom and secure the blade assembly by turning it

anti-clockwise until tight (See Fig.3)

2) Reposition the jar assembly with its opening upwards. Wrap the seal ring 1 around the lid bottom and put the lid onto the jar assembly. Place the measure cup exactly into the lid by fitting the small projection on the both sides of the cup into the slots of the lid and turning the cup clockwise until tight. (See Fig.4)

3) Finally, place the assembled jar onto the motor unit by aligning the strip on the assembled jar bottom. (See Fig.5)

4) Disconnect from power supply once finished. Disassemble the grinding attachment from the unit, keep the grinding bowl downward and turn it anticlockwise (See Fig.6), then empty the bowl and serve.

CAUTION: Jar and jar base is now secure. Do not try to twist the jar and jar base onto motor unit

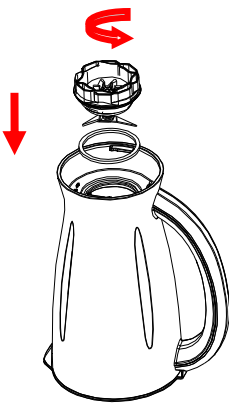

Fig.3

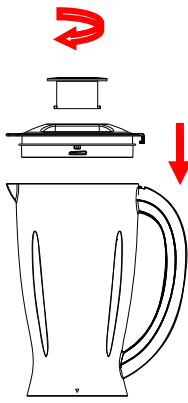
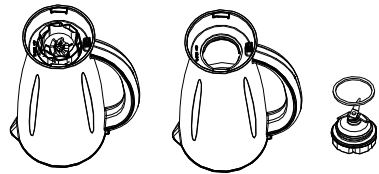

Fig.4



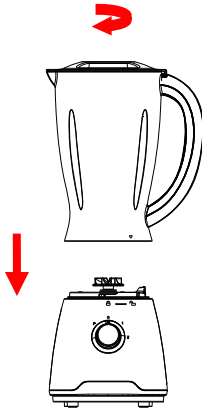

Fig.5

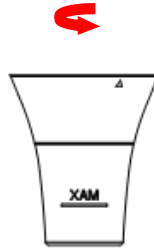

Fig.6

How to use

1. Peeled or cored the fruit or vegetables and then cut it into small dices.
2. Place the food to be blended into the jar (See Fig.7) .
Usually, certain amount of purified water has to be added to facilitate the smooth running of appliance. The proportion of the food and water is 2:3.The amount of mixture should not exceed the max level as indicated on the jar.

RECIPE

FOOD TYPE	SPEC	WEIGHT	SPEED
Carrot (apple, pear etc.)	Cut into 15mm*15mm*15mm	Carrot: 600g Water: 900g	High speed

Note: never use boiling liquids or run the appliance empty.

3. Put the lid on the jar. Be sure the measuring cup is in place.
4. Plug the power cord into a standard wall outlet.
5. Turn the speed knob to the appropriate speed setting for your task.
6. For quick or delicate blending tasks, turn the speed knob to P position and hold for a few seconds and then release, the knob will reset to O position automatically. Operate several times until the consistence you want is obtained
7. If you want to add ingredients while the blender is working, remove the measuring cup and place through the lid opening. (See Fig.8)
8. When crushing ice or hard food, keep one hand firmly on the lid.
9. When the consistence you desire is obtained, turn the knob to O position.

Note: 1) For each use, the consecutive operation time should not exceed 3 minutes. at least 10 minutes rest time must be maintained between two continuous cycles, let the unit cool to room temperature before performing next operation cycle.

2) For each use, the consecutive operation time of Grinding cup should not exceed 30 Seconds. at least 10

minutes rest time must be maintained between two continuous cycles, let the unit cool to room temperature before performing next operation cycle.

3) If you want to stop the machine during operation, turn the knob to O position anytime.

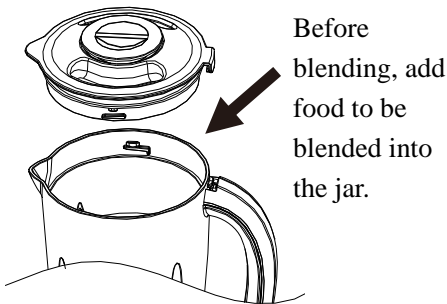

Fig.7

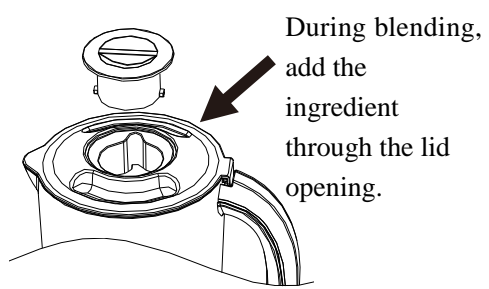

Fig.8

Important operating tips

- For best circulation of food that are to be blended with some liquid, pour the liquid into the jar first, then add solids.
- Some of the tasks that cannot be performed efficiently with a blender are: beating egg whites, whipping cream, mashing potatoes, grinding meat, mixing dough, extracting juice from fruit and vegetable
- The following items should never be placed in the unit as they may cause damage: bones, large pieces of solid, frozen food,

or tough foods such as turnips.

- To crush ice, add up to 6 ice cubes. If more ice is needed, remove the cup and add cubes one by one through the lid opening.

CARE AND CLEANING

This product contains no user serviceable parts. Refer service to qualified service personnel.

1. Before cleaning, unplug the blender.
2. Always wash immediately after use for easier cleaning. Don't let food dry on the jar assembly as this will make cleaning difficult.
3. Pour a little warm soapy water into the jar and turn the knob to P position for a few seconds. And then empty the jar.
4. Dismantle all detachable parts. Lift the jar assembly off the motor unit, To detach the blade assembly by turning it clockwise from the jar base bottom , and remove the seal ring 2 and blade assembly (see fig.9). In addition, detach the jar cover seal ring 1 from the jar cover.

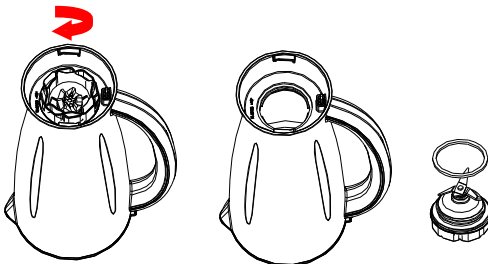

Fig.9

5. Rinse the measure cup, lid, seal ring 1, jar, seal ring 2 and blade assembly by hands or in a dishwasher and then dry. They are dishwasher safe components, but the temperature setting shall not exceed 70°C.
6. Brush the blade clean using warm soapy water, then rinse thoroughly under the tap. Don't touch the sharp blades, handle carefully. **Don't immerse the blade assembly in water.** Leave to dry upside down away from children.
7. Wipe the motor unit with a damp cloth and dry thoroughly. Remove the stubborn spots by rubbing with non-abrasive cleaner. If liquids spill into the motor unit; first unplug the unit, then wipe with a damp cloth and dry thoroughly.

CAUTION

- 1) **Do not immerse the motor unit in liquid to prevent the risk of electric shock.**
- 2) **Do not use rough scouring pads or cleansers on parts or finish.**

ENVIRONMENT FRIENDLY DISPOSAL



You can help protect the environment!
Please remember to respect the local regulations: hand in the non-working electrical equipments to an appropriate waste disposal centre.